



**RECONNECTING  
THE RIVERFRONT**  
 DOWNTOWN WESTPORT

**PARKER HARDING PLAZA**

April 6, 2023

## AGENDA:

- Boardwalk
  - Material options and locations
  - Relationship to future Jesup Green
  - Pedestrian only and rated
- Guardrail
  - Material selection
  - Relationship to boardwalk
- Coordination items
  - Bench details, locations, relationship to adjacent materials
  - Quick page turn of 30% CD
  - Signage



## UPCOMING DELIVERABLES:

- |      |                                                |
|------|------------------------------------------------|
| 3/16 | 30% Construction Documents                     |
| 4/28 | 70% Construction Documents                     |
| 5/18 | Pricing discussion with working group (70% CD) |
| x/xx | 100% Construction Documents                    |
| x/xx | SD Deliverable for Jesup Green + Imperial Lot  |
| x/xx | Begin construction                             |

## Project Timeline

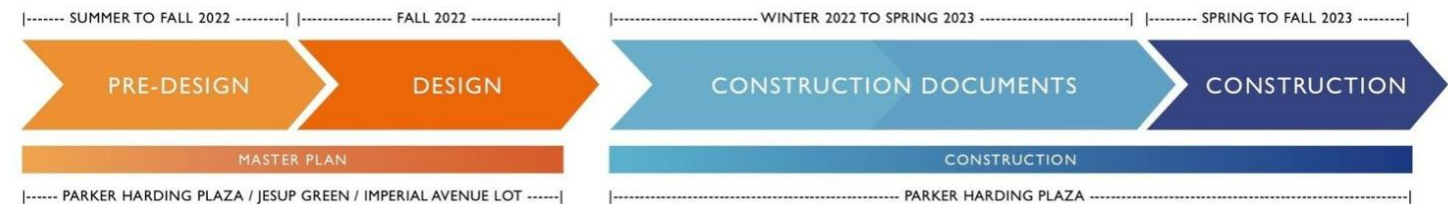



WOOD AND CABLE



1

WOOD BOARDWALK



2

WESTPORT BRICK



3

EXPOSED AGGREGATE



4

STAMPED ASPHALT



5

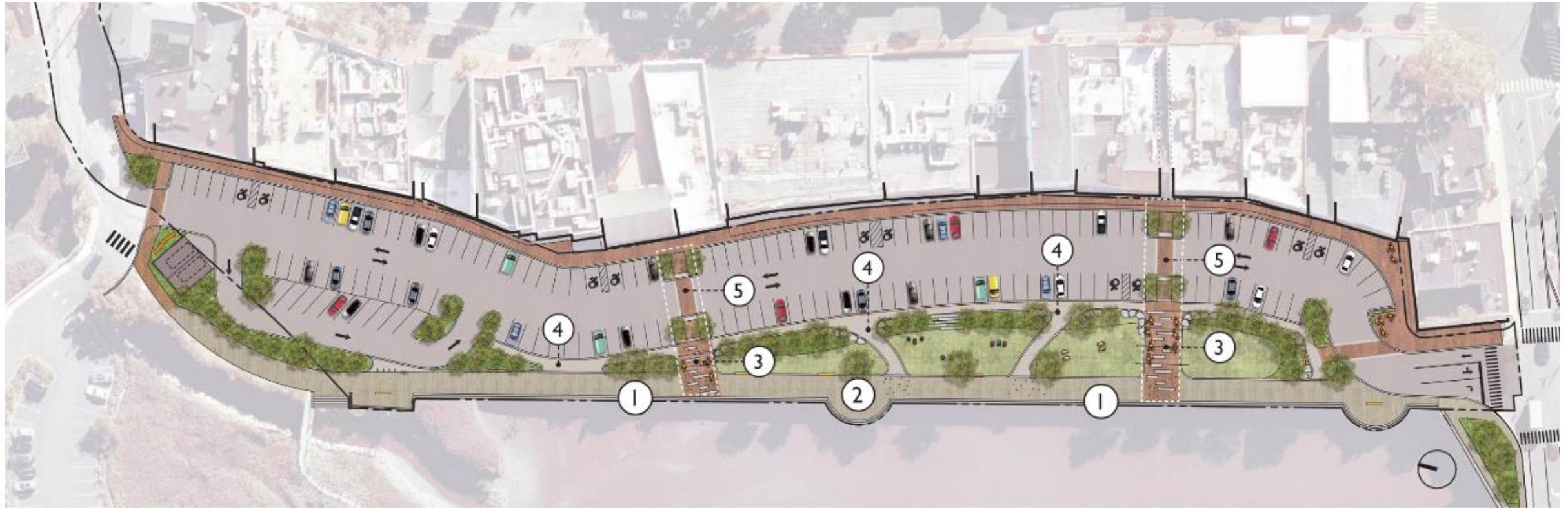

## Schematic Design

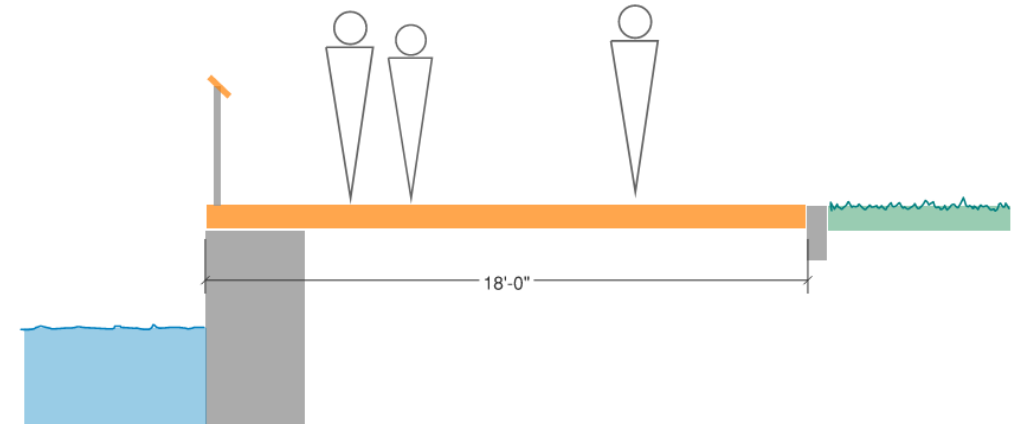
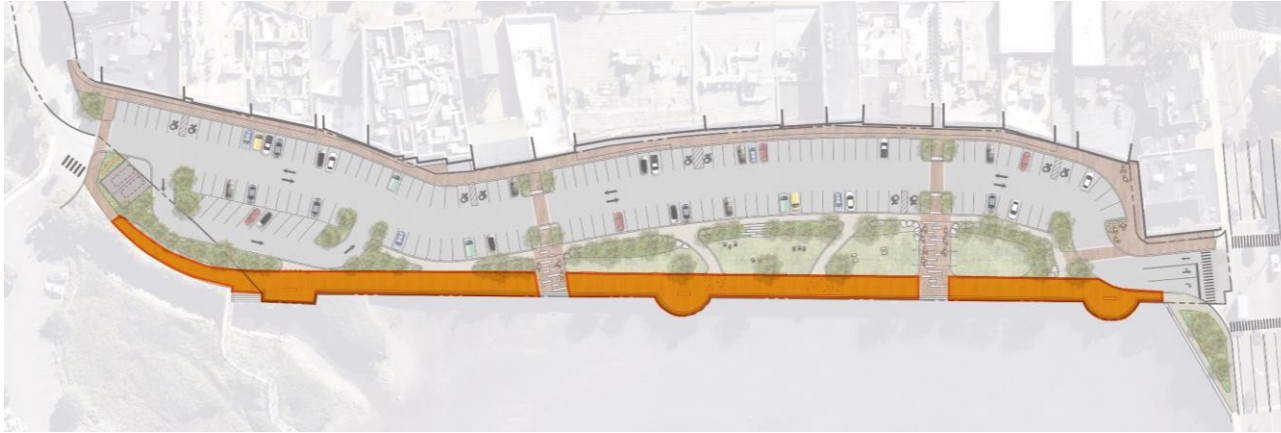

## Construction Documentation

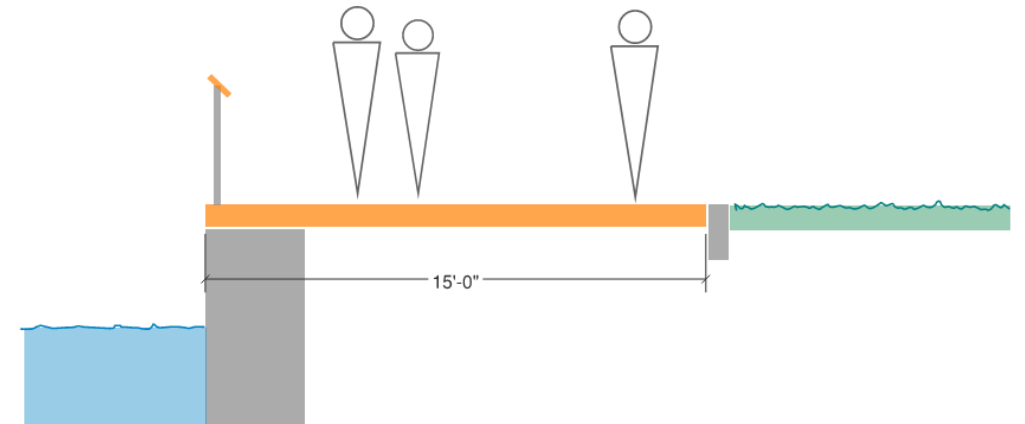
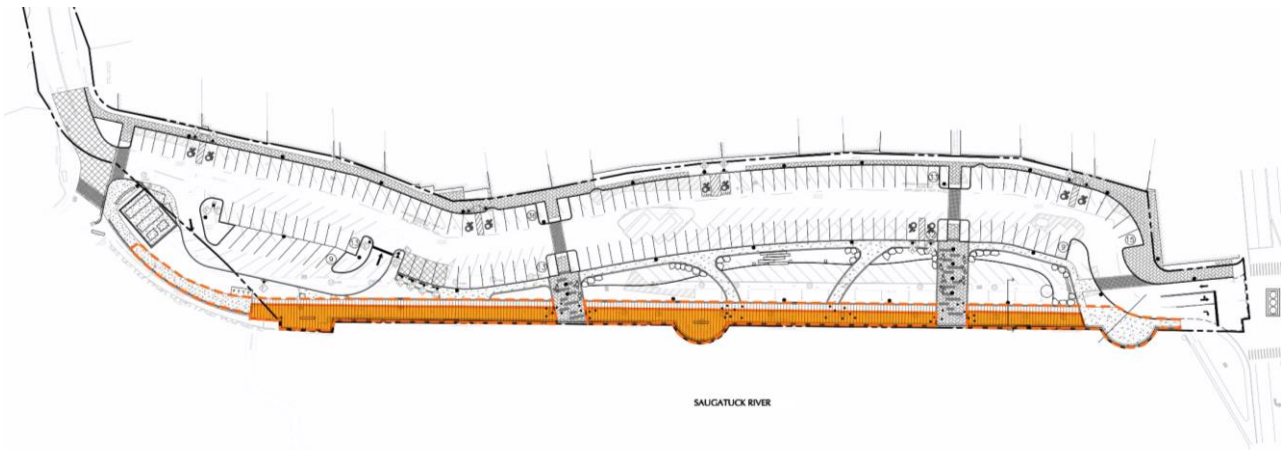

Reduction of wood decking = 5,000 sf

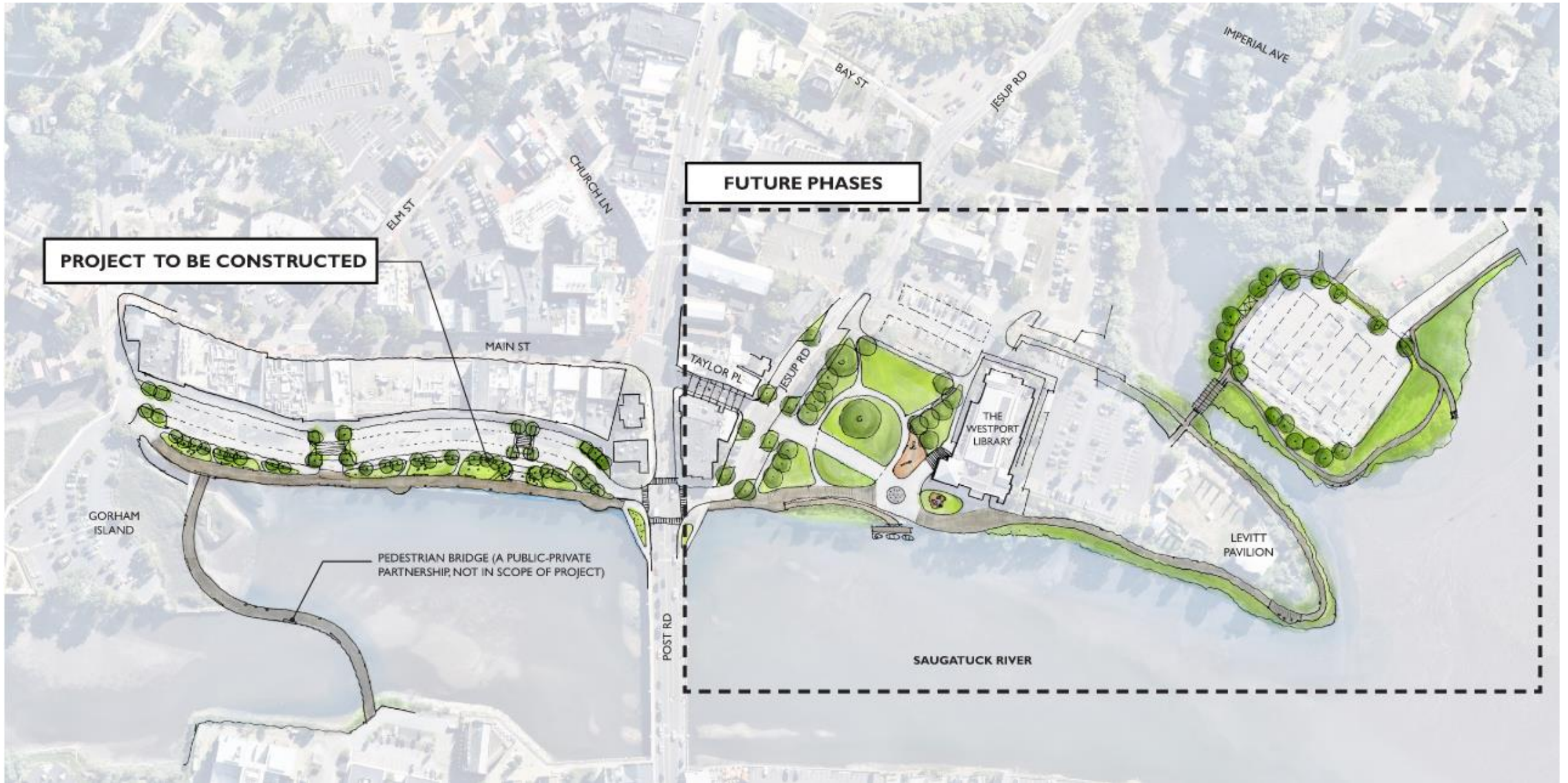

## Ipe Wood

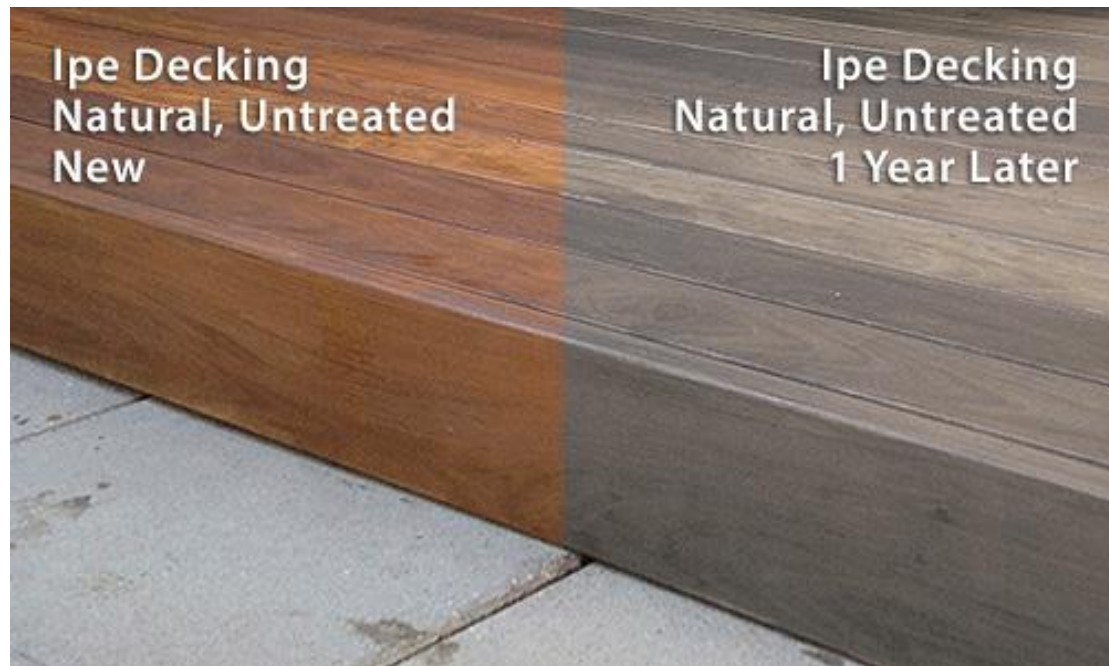

Photo of High Line with Ipe wood decking

- Tropical Hardwood, certified by the Forest Stewardship Council
- Highly durable, low maintenance
- Highly dense material
- Tight grains resist water intrusion and does not splinter
- Unfinished wood will weather to attractive, natural gray patina
- If required, wood can be sanded with the grain to maintain smoother surface

## Southern Pine Decking



### Marine Environments:

Southern Pine lumber is a natural choice for sensitive marine environments, and its use for marine service includes a wide range of commercial applications such as docks, piers, marinas, bulkheads, boardwalks and light vehicular bridges.

### Maintenance:

- Snow removal – Bobcat vs. shoveling, natural salting material
  - **Trackless in Westport = most efficient**
- Boardwalk is not main egress pathway
- Potential application of sealer every two to three years

### Overall Benefits / Characteristics:

- Cost savings
- Strong, durable material in marine environment
- Readily available in eastern states and renewable resource:
  - improving local economies,
  - reducing transportation costs
  - minimizing impacts on the environment
- Superior fastener-holding power and load-bearing capacity
- Distinct grain pattern and an appealing golden color



**Precast Concrete Pavers  
(polymeric sand setting bed)**



**Precast Stamped Concrete  
with Integral color**



## Ipe Wood



Reduction of wood decking

## Southern Pine Decking



Reduction of wood decking + switch material

## Precast Concrete Pavers

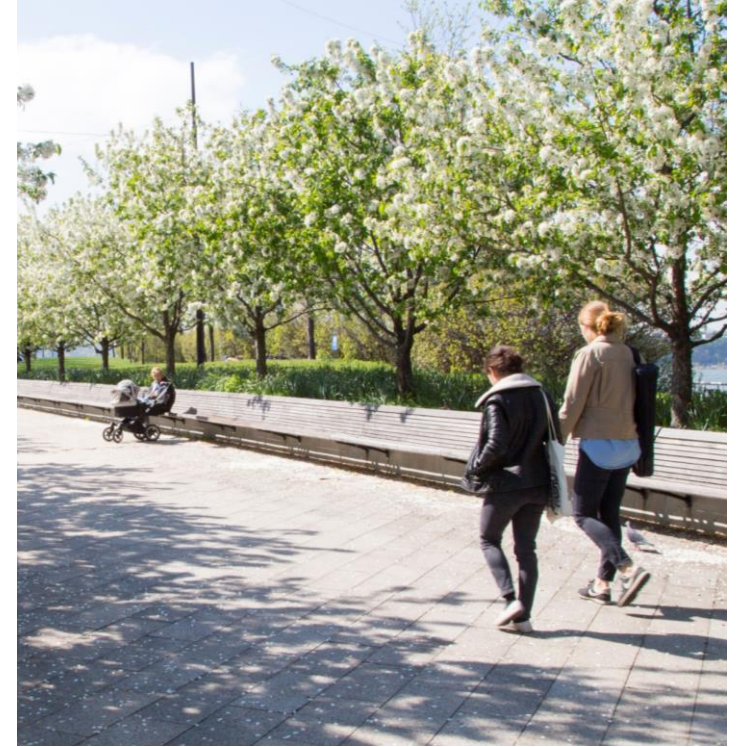

Reduction of wood decking + switch material

**Cable Guardrail**



**Jakob Rope System**



**McNICHOLS Wire Mesh**

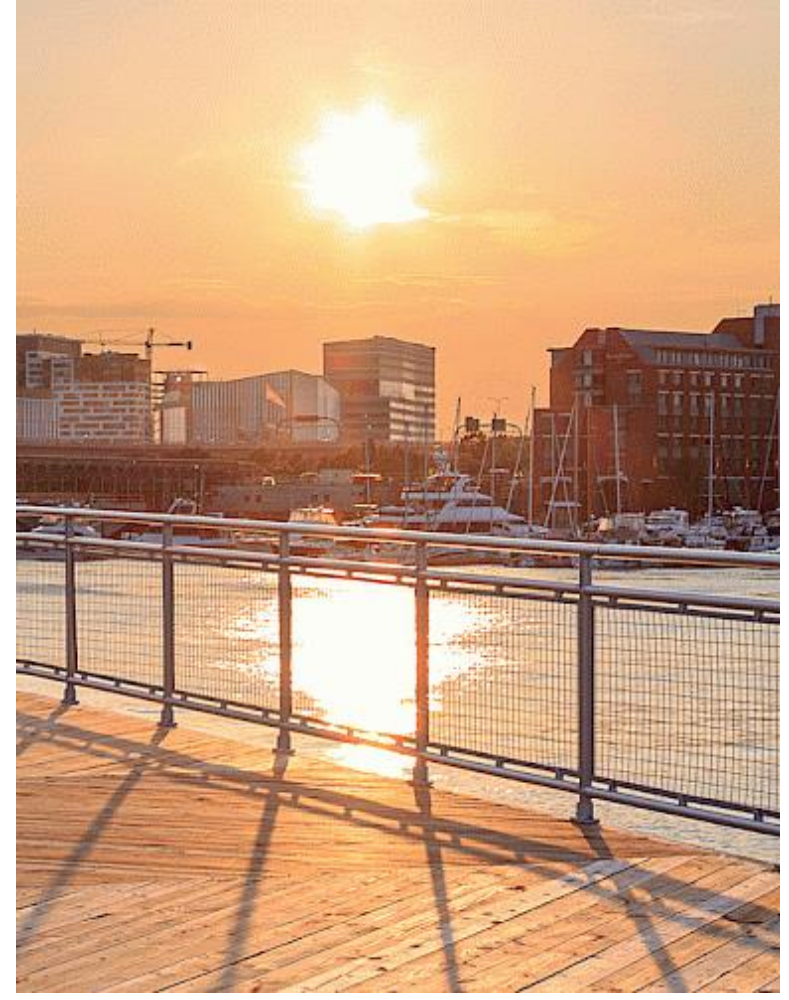





**Bench along Boardwalk**  
10' x 18" x 24" Granite  
with wood top



**Signage**  
(2) on guardrail top  
(2) Monumental signs  
(2) within stormwater/planting

**Bench along Boardwalk**  
Westport standard bench  
Cordia by Forms + Surfaces



**Pole Lights**  
Align with Westport  
Downtown fixtures

**Granite curb**  
Align with Westport  
Downtown materials

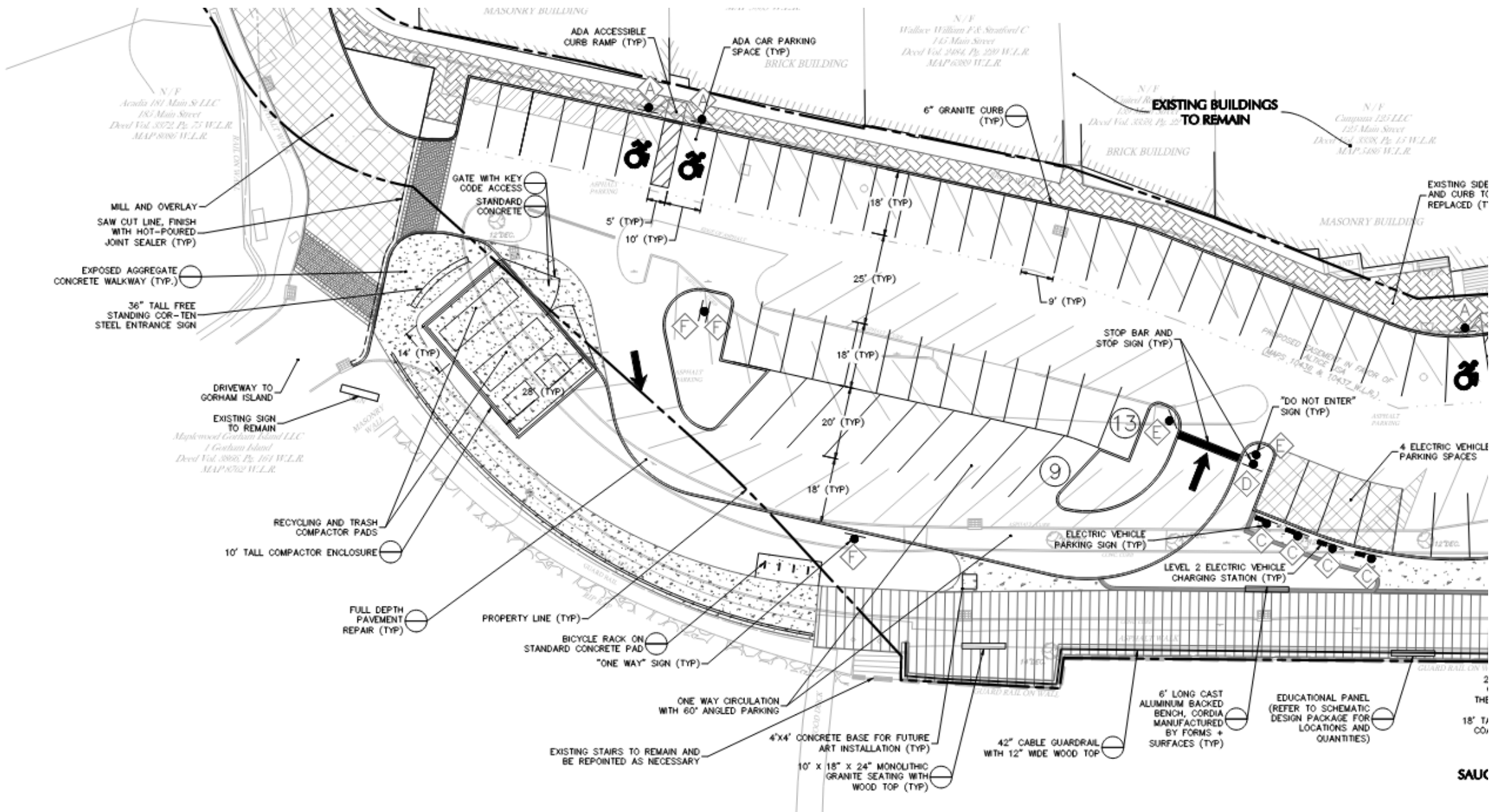

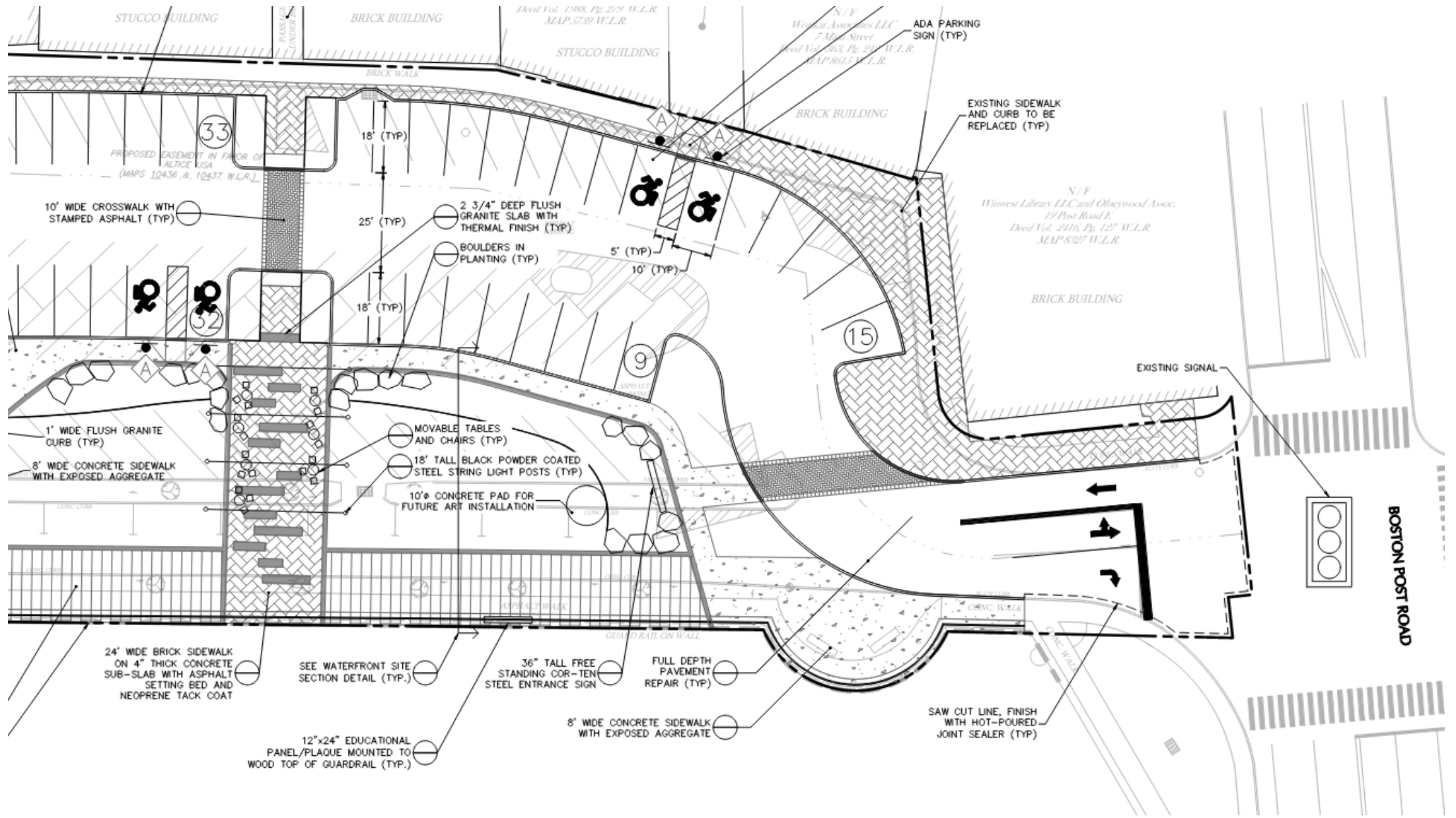

**AGENDA:**

- Boardwalk
  - Material options and locations
  - Relationship to future Jesup Green
  - Pedestrian only and rated
- Guardrail
  - Material selection
  - Relationship to boardwalk
- Coordination items
  - Bench details, locations, relationship to adjacent materials
  - Quick page turn of 30% CD
  - Signage



**UPCOMING DELIVERABLES:**

- |      |                                                 |
|------|-------------------------------------------------|
| 3/16 | 30% Construction Documents                      |
| 4/28 | 70% Construction Documents                      |
| 5/03 | Submission (need to integrate boardwalk finish) |
| 5/18 | Pricing discussion with working group (70% CD)  |
| x/xx | 100% Construction Documents                     |
| x/xx | SD Deliverable for Jesup Green + Imperial Lot   |
| x/xx | Begin construction                              |

**Project Timeline**

